

SEE VOL. ONE

ARMY

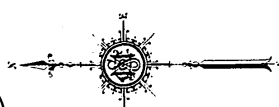

Spokane River (South Channel)

THIS RISK NOW SHOWN ON VOL. 8 SHEET 831

EDGECLIFF SANATORIUM (COUNTY TUBERCULAR) LOC. 4 MI. E. OF SPOKANE-1 MI. S.W. OF DISMAN

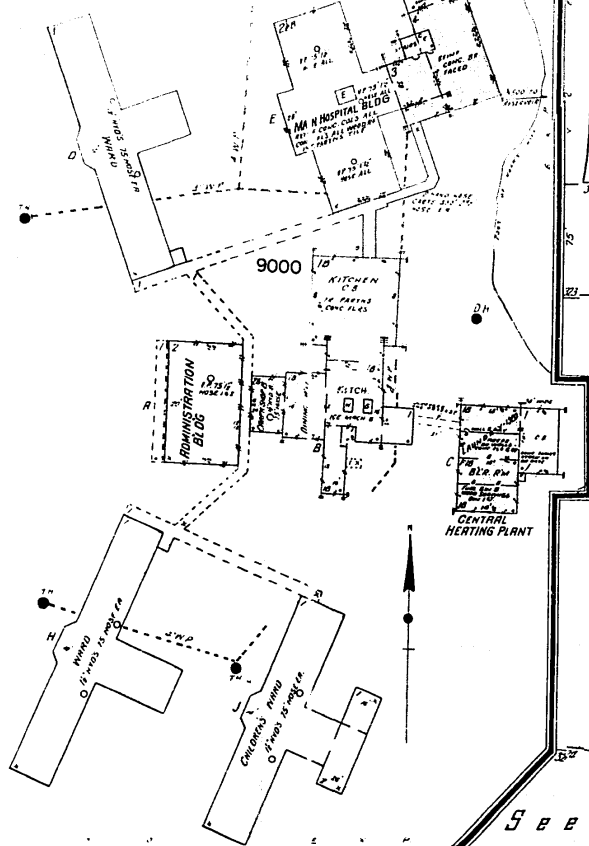

UNION PASSENGER DEPOT

WASHINGTON

STEVENS

HOWARD

CHICAGO, MILWAUKEE & ST. PAUL RY. CHICAGO, FREIGHT & HO.

TRENT AV. (FRONT)

BERNARD

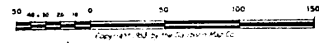

COPY